

# Log Home Planbook



**CedarDirectLogHomes.com**  
**800.661.5647 (LOGS)**

Copyright © 2009 Cedar Direct, Inc. All Rights Reserved



# The Cedar Direct International Family

Cedar Direct, Inc. (CDLH) is a family owned and operated business located in Wexford, PA, just outside Pittsburgh, Pennsylvania, the City of Champions. Family is important at CDLH and having the perfect log home at the perfect price for your family is our primary objective.

Cedar Direct International recently received Best of Wexford Award for Building Materials.

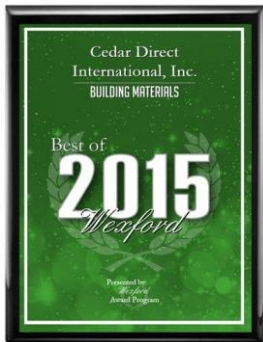

Our office is located in our home and is available for viewing by private appointment only. Private appointments are also available upon request for your convenience on evenings and weekends.

Cedar Direct International offers you an Eco-Friendly and Energy Efficient log home boasting all the amenities of log home living without the destructive costs to the

environment. CDLH has also partnered with local manufacturers, helping our customers Go Green with companies they can trust. For additional information, see our "Go Green" sheet.



At Cedar Direct International, quality is number one. We have chosen Northern White Cedar as the primary wood for our log home packages because of its many aesthetic and structural advantages. The USDA Forestry Division ranks it as one of the three best woods to use in exterior building. moisture content, and requires very little thermal efficiency, and in fact, it has the highest R best insulating qualities for your new log home. ability to resist rot, fungi, and wood infesting stable, and as beautiful as it is durable. For Sheet. We have designed, shipped, and built finest stains, sealants, and caulk in our log home throughout your log home.



If you need assistance in locating a builder, our log homes or expressed an interest in building construction from "Under Roof" to "Turnkey". For the true pioneer, we provide training and toll free technical assistance.

CDLH will provide you with a fast computerized quotation for any custom design of choice free of charge and assist you in designing your dream log home at no additional charge. CDLH provides custom CAD blueprints with the purchase of a complete log home package.

If you need assistance with locating property, we can point you in the right direction locally through a list of qualified realtors who specialize in locating land for our clients. Financing for log homes has been complex in the past, but CDLH makes it easy with many owner/builder options at competitive rates for our log homes through local lending institutions. We can provide you with a list of financial institution that have a history of financing log homes.

Don't be fooled by what appears to be "LOW" kit prices. The cost of the package in relationship to the price of the completed log home is irrelevant based on what is included in the package. At CDLH, we do not rely on unreliable multipliers to determine the final cost of your log home. We believe each log home must be priced individually based on the design and the type of interior products you plan to use.





# The Montpelier



3,060  
Square Feet

First Floor Plan



Second Floor Plan

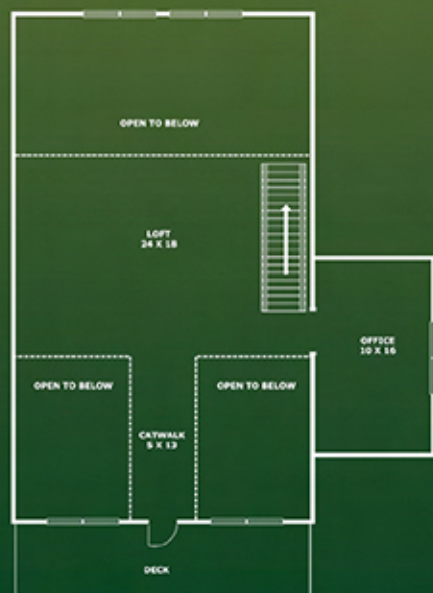



# The Fern Mountain

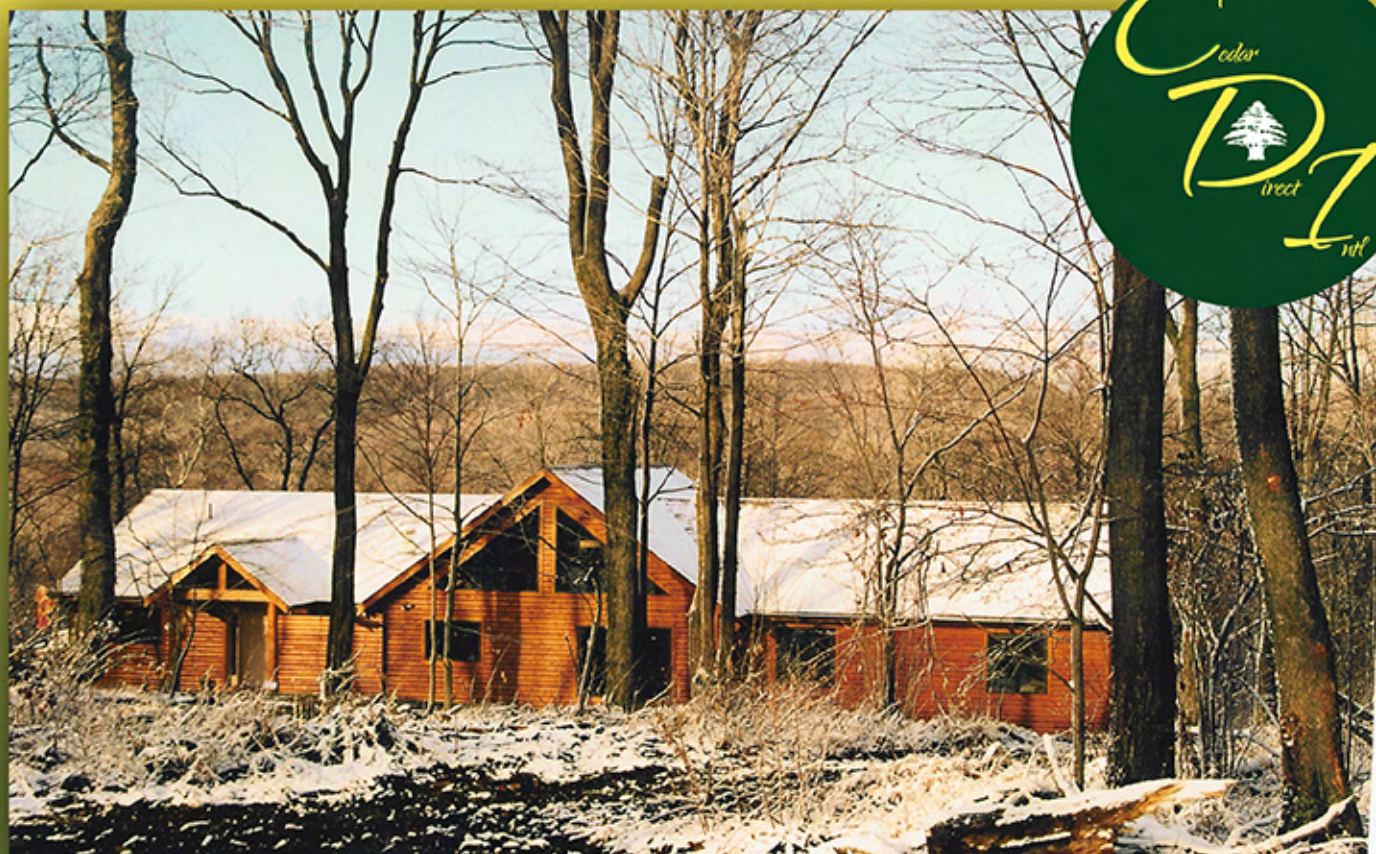

3,012  
Square Feet

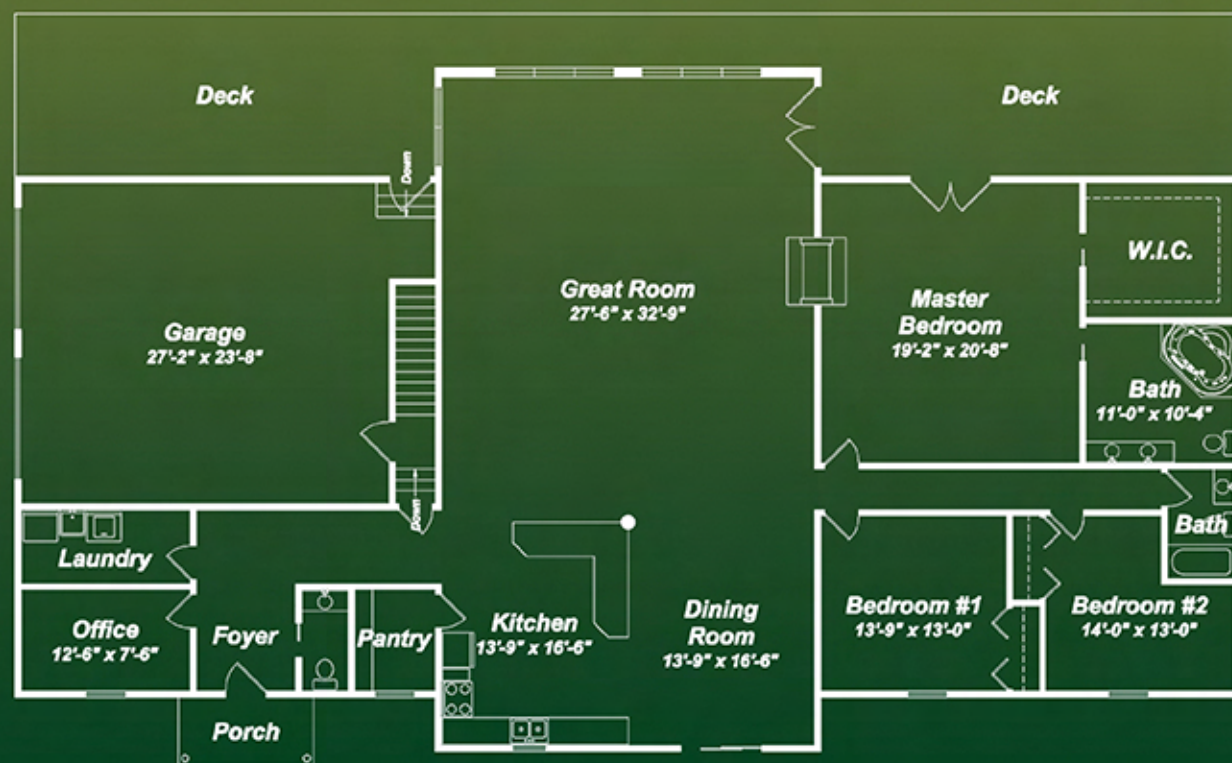



# The Timber Ridge



3,084  
Square Feet

Second Floor Plan

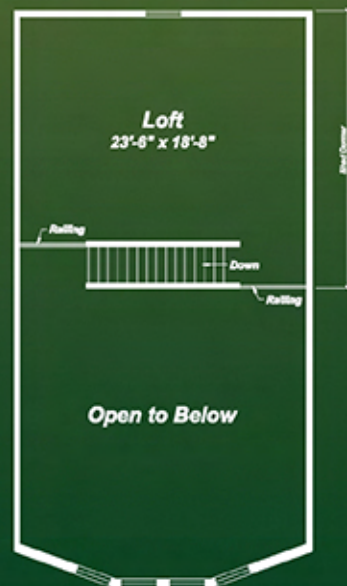

First Floor Plan

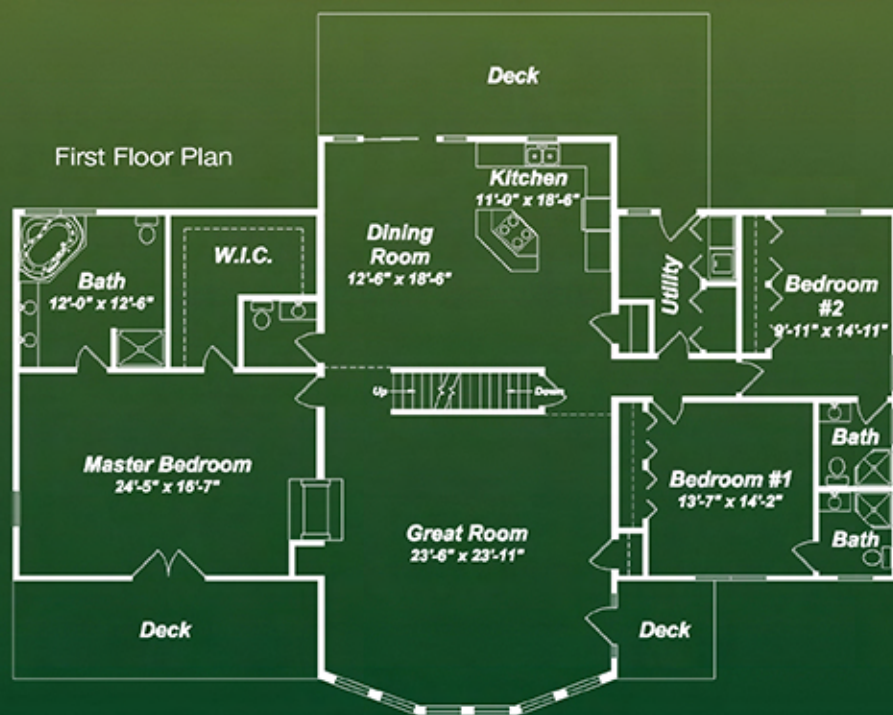



# The Treasure Lake



3,344  
Square Feet

First Floor Plan

Second Floor Plan

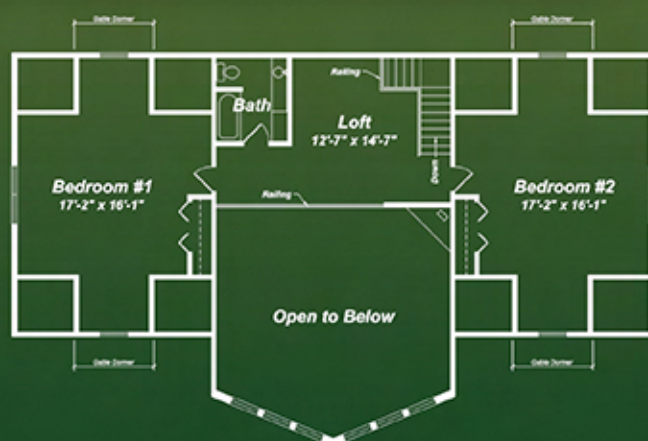
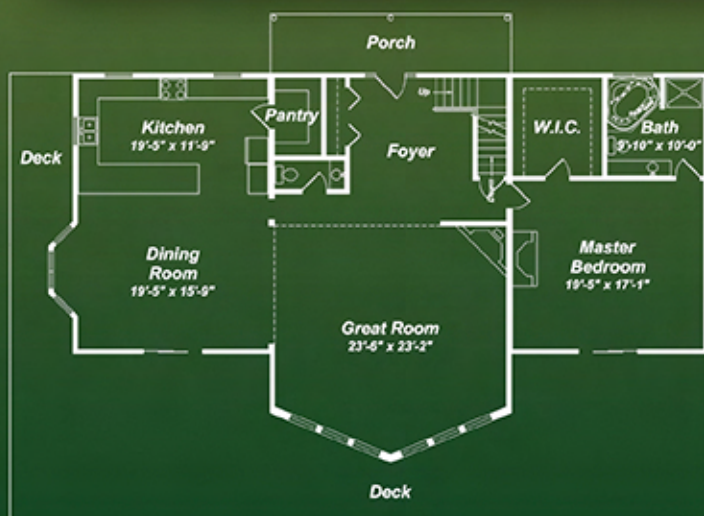



# The Artisan Lodge



3,708  
Square Feet

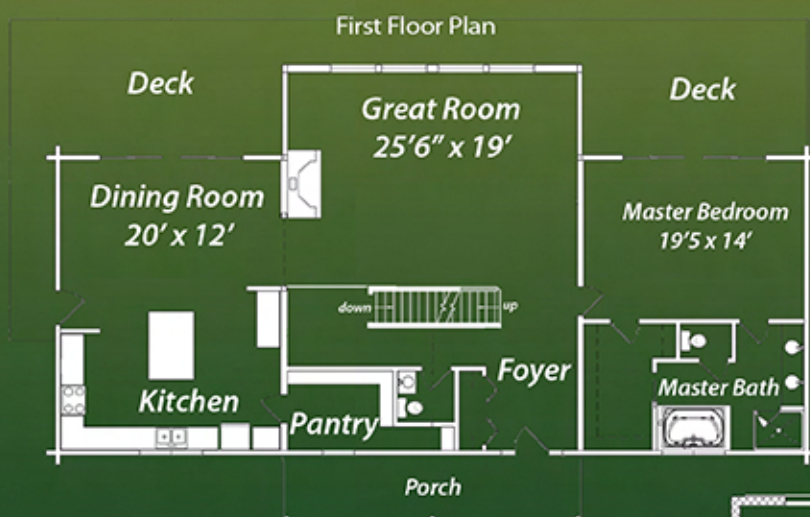

Second Floor Plan

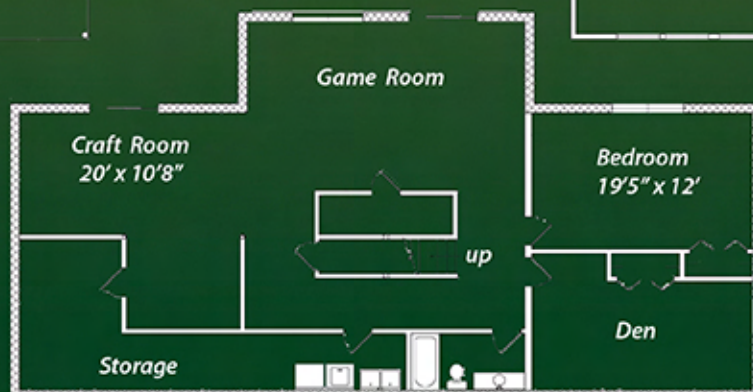
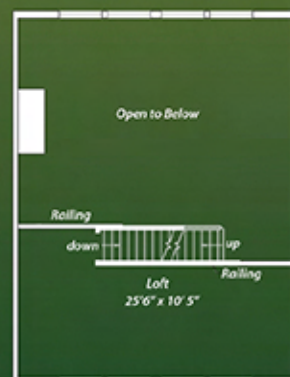



# Cedar Crest Estate



4,464  
Square Feet

First Floor Plan

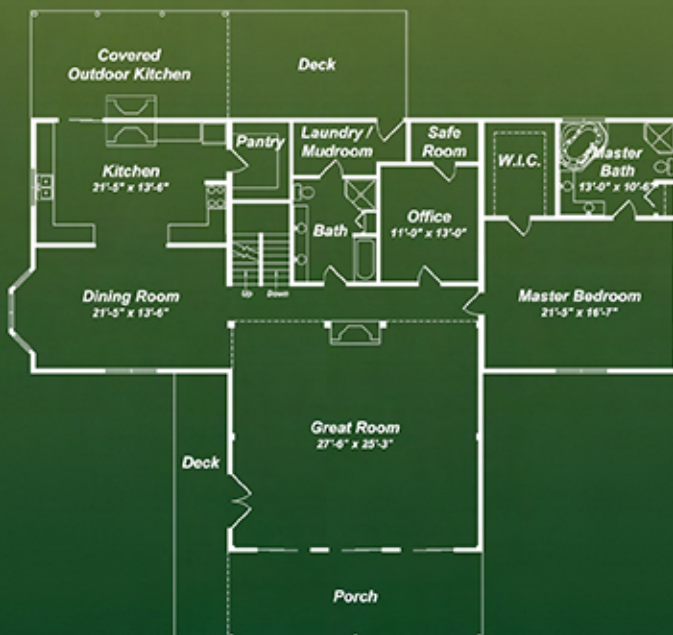

Second Floor Plan

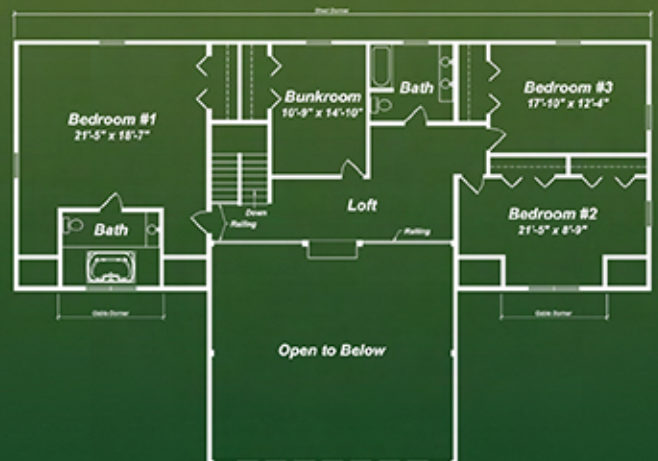



# The Lakeside Estate



6,912  
Square Feet

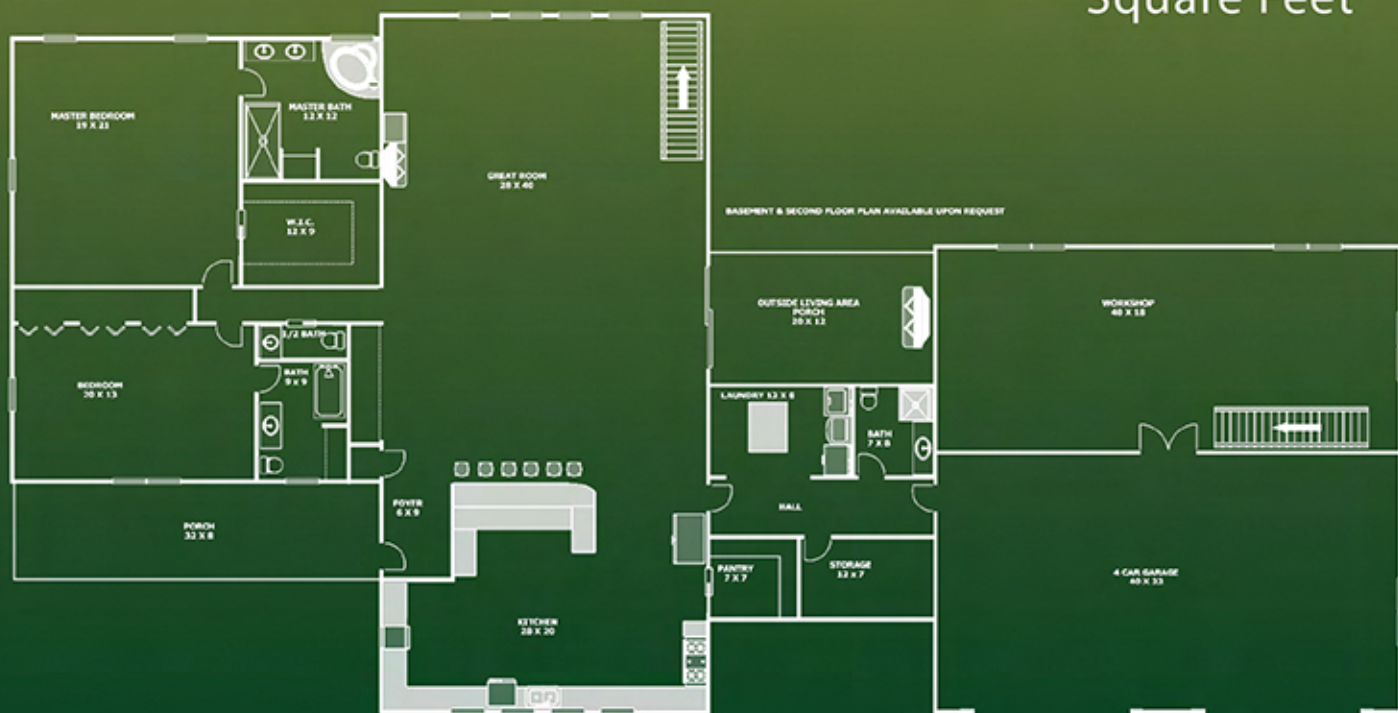



# The Gathering Timbers



2,758  
Square Feet





# The Gathering Timbers

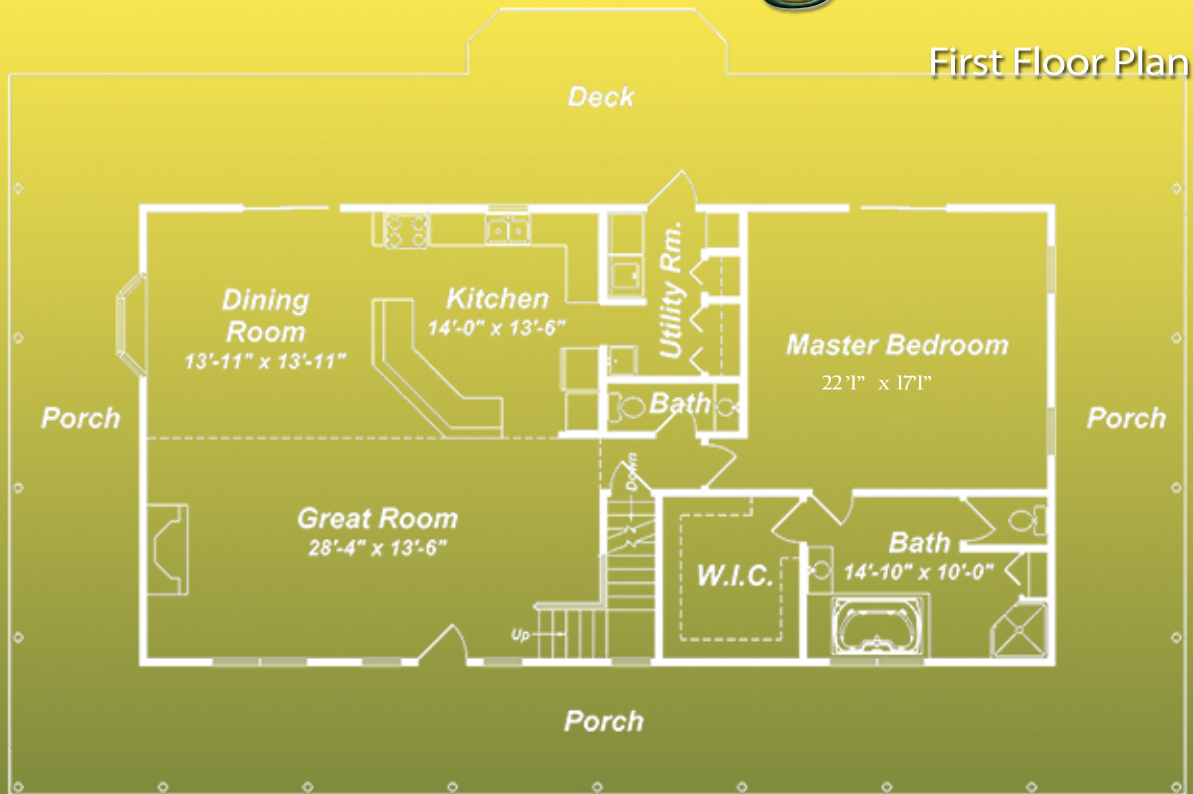

2,982  
Square Feet

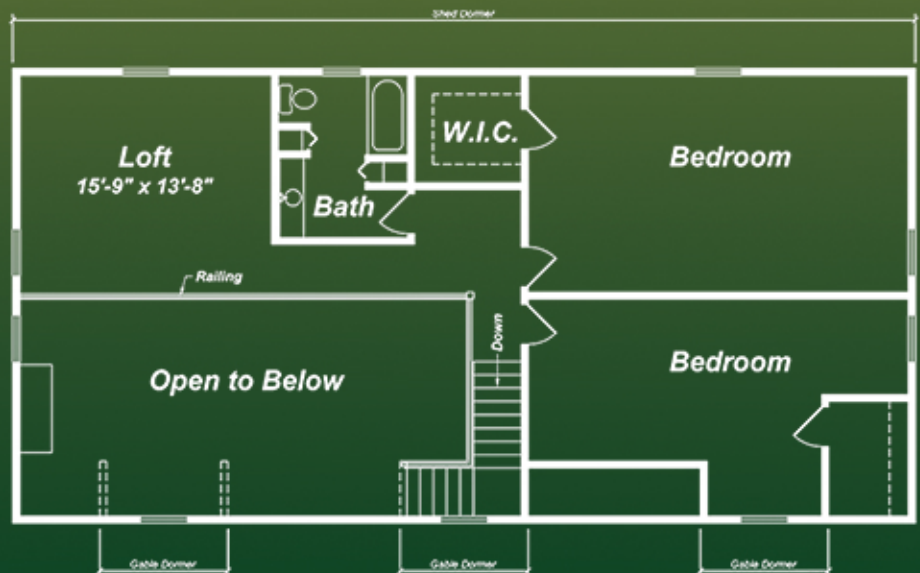

Second Floor Plan



# The Bluestone Lake



4,704  
Square Feet





# The Bluestone Lake

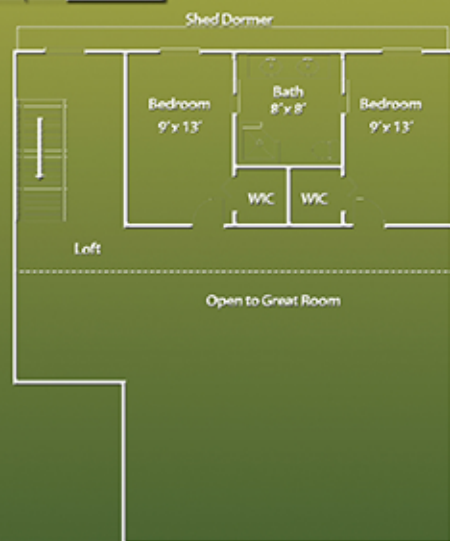
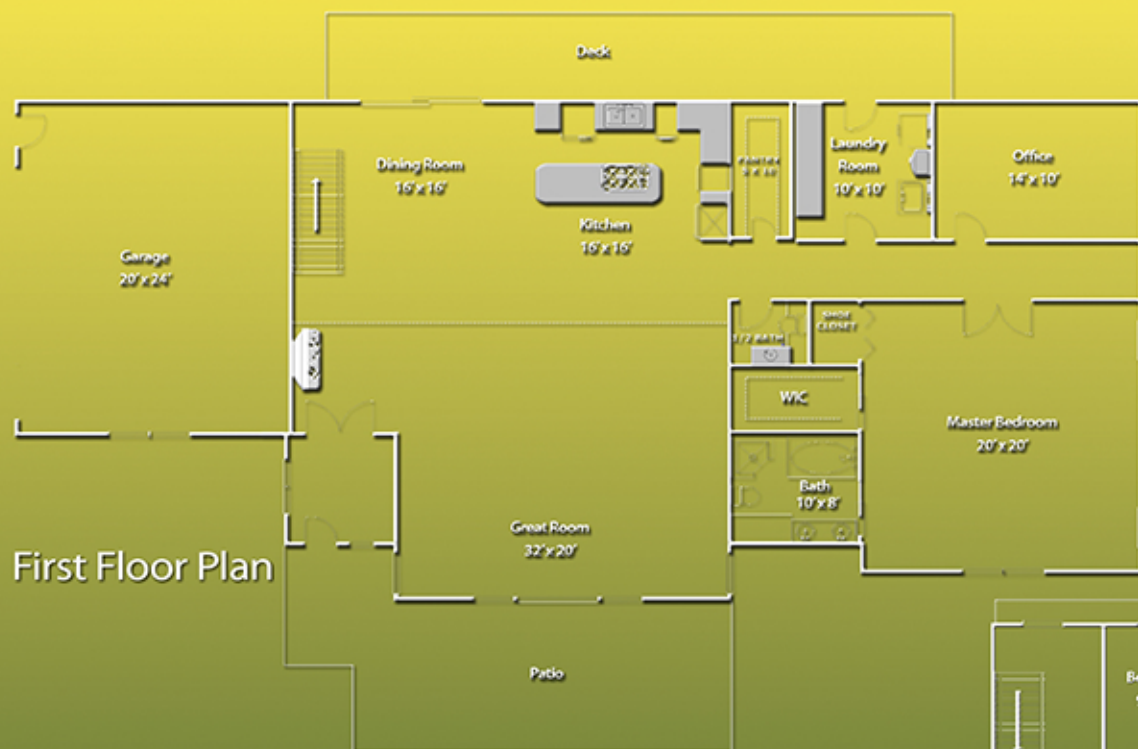

**4,704  
Square Feet**

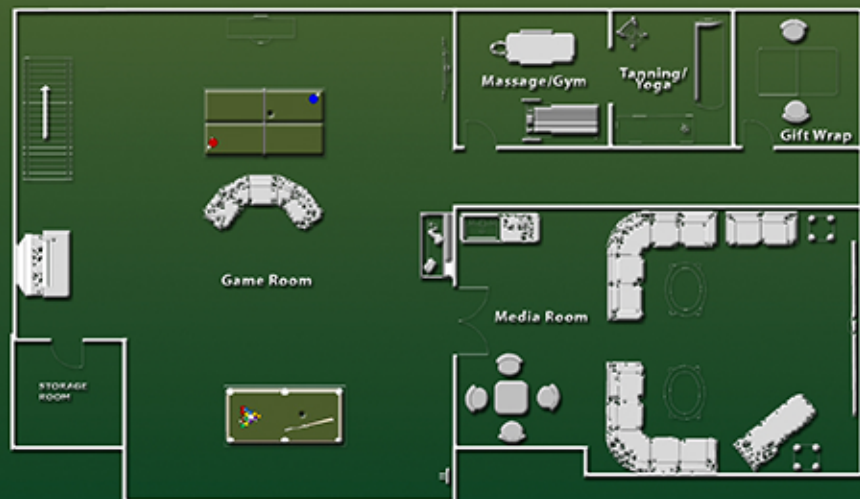

## Second Floor Plan

## 1.800.661.LOGS

Copyright © 2009 Cedar Direct, Inc. All Rights Reserved



# The Grand Villa



5,340  
Square Feet





# The Grand Villa

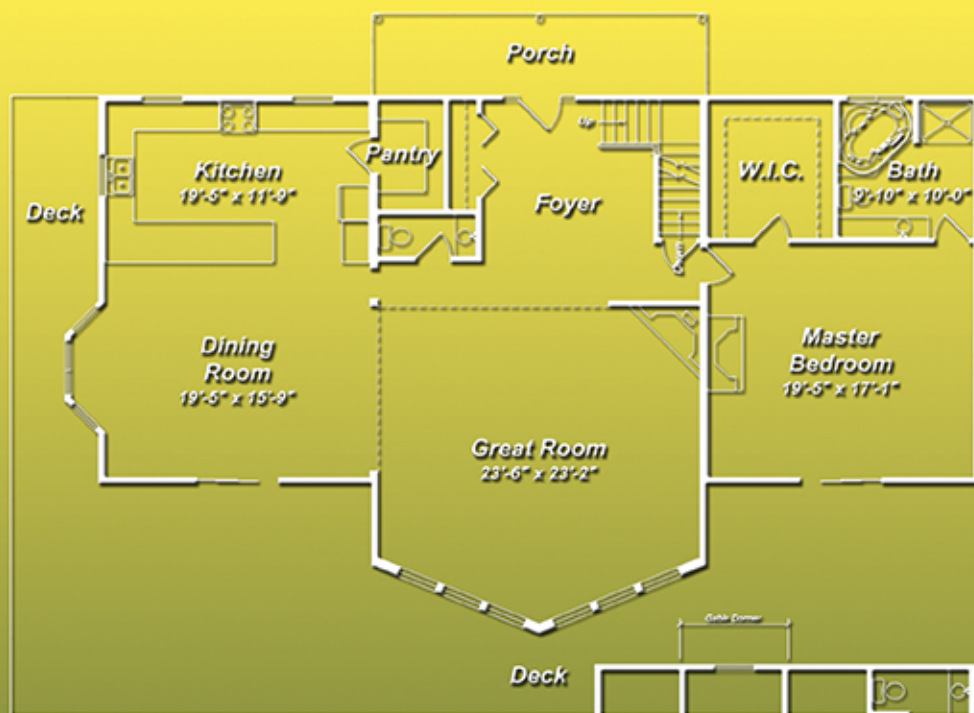

First Floor Plan

**5,340  
Square Feet**

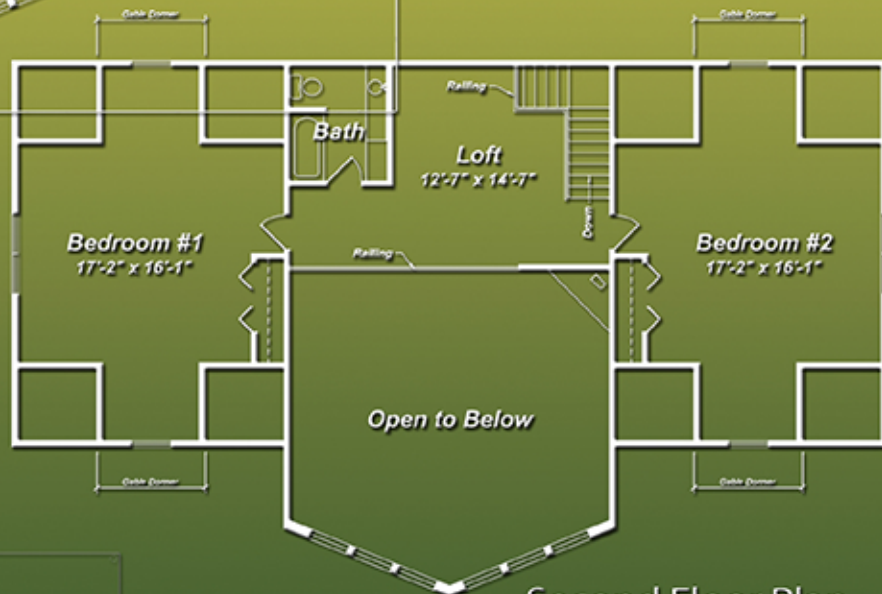

Second Floor Plan

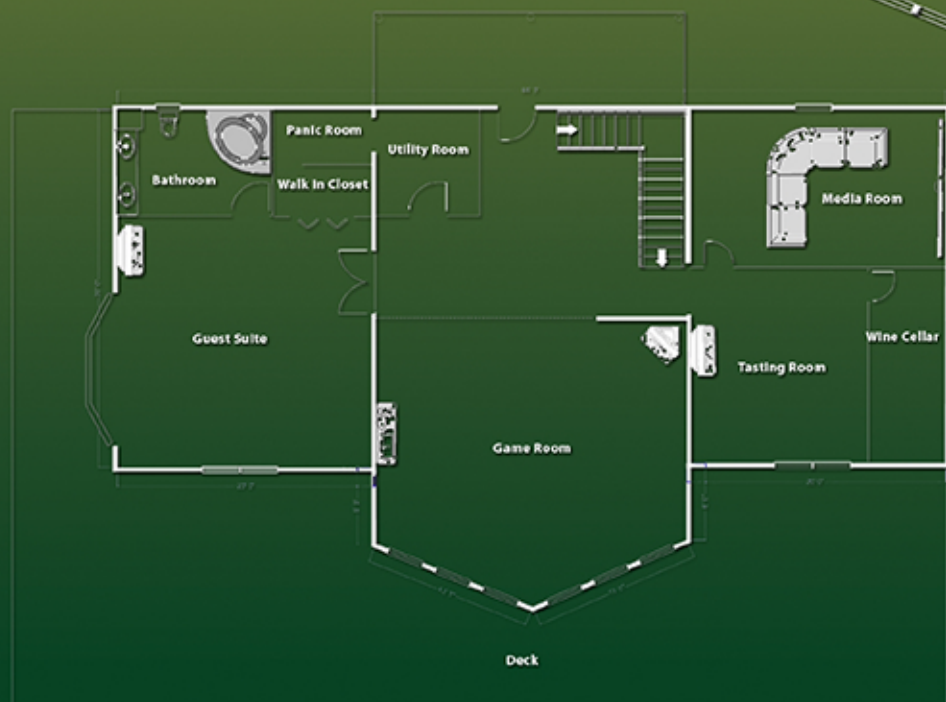

Lower Level Floor Plan



# The Mountain Lair



6,368  
Square Feet





# The Mountain Lair

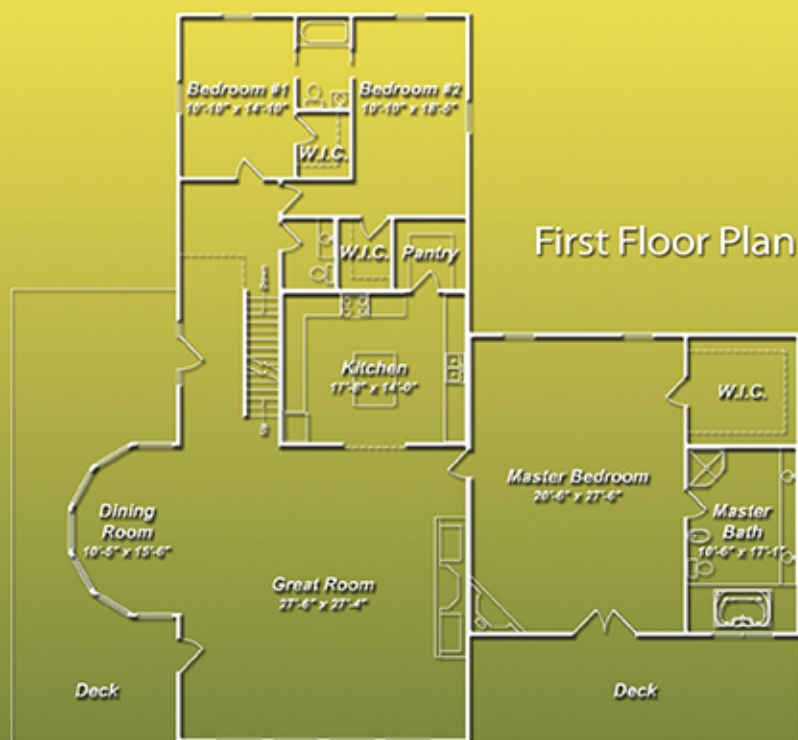

Second Floor Plan

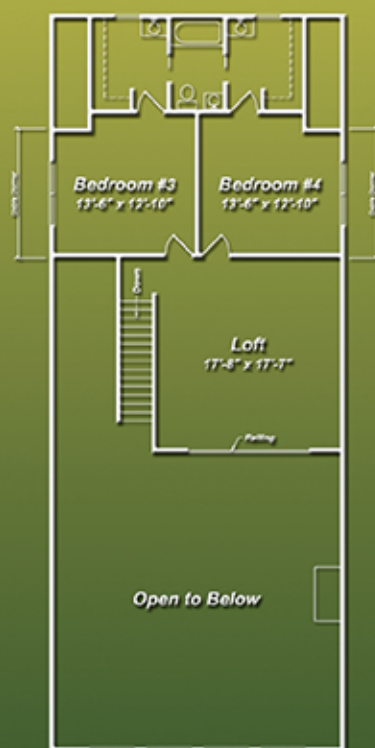

**6,368  
Square Feet**

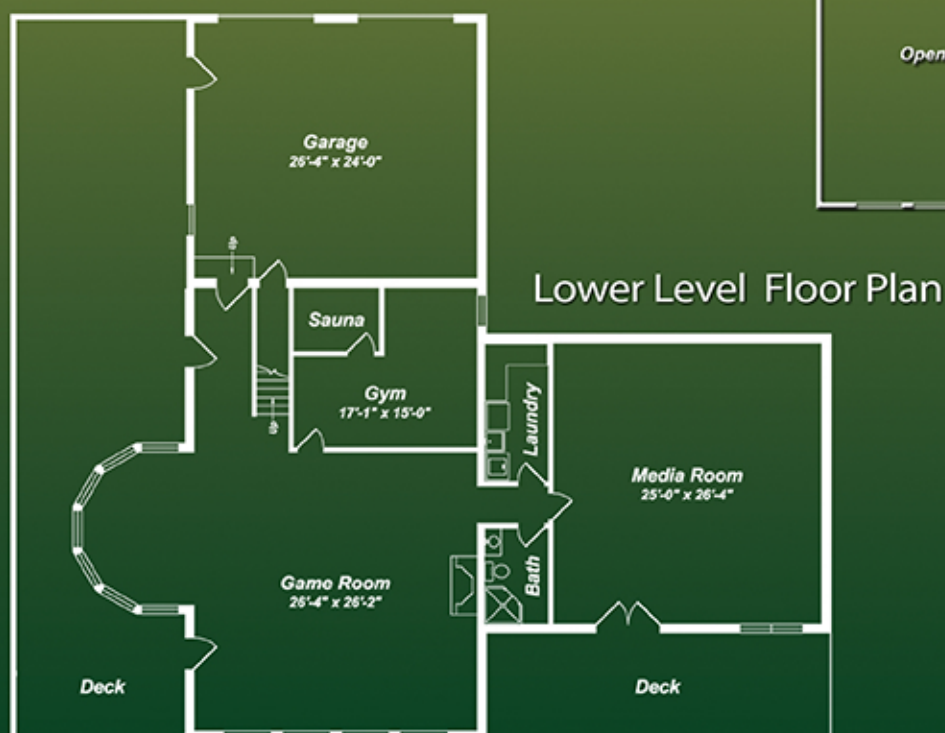



# The Black Bear Crossing



5,396  
Square Feet





# The Black Bear Crossing

## First Floor Plan

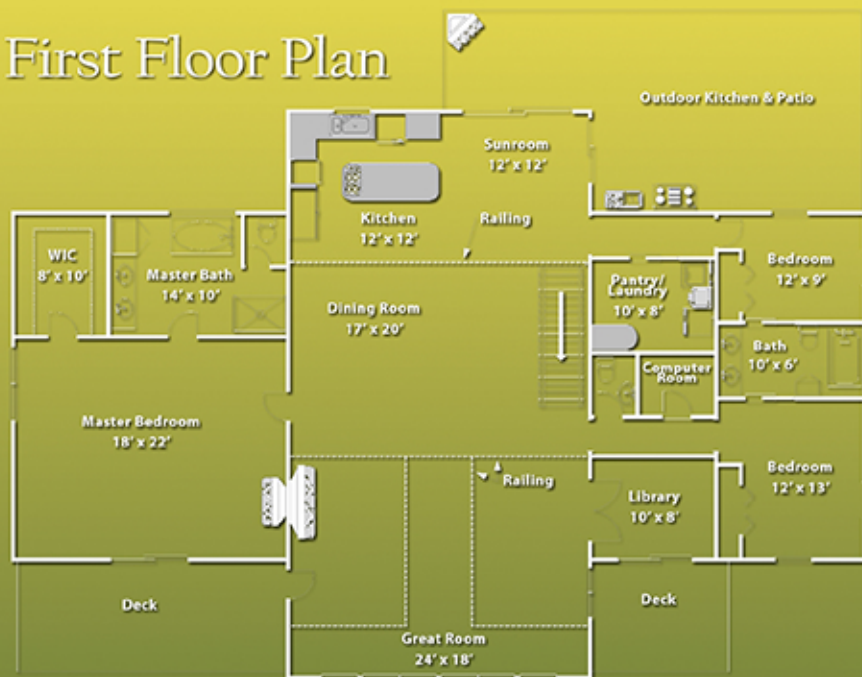

## Second Floor Plan

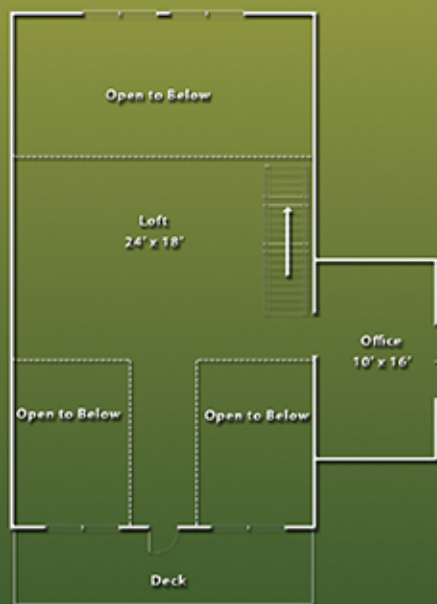

5,396  
Square Feet

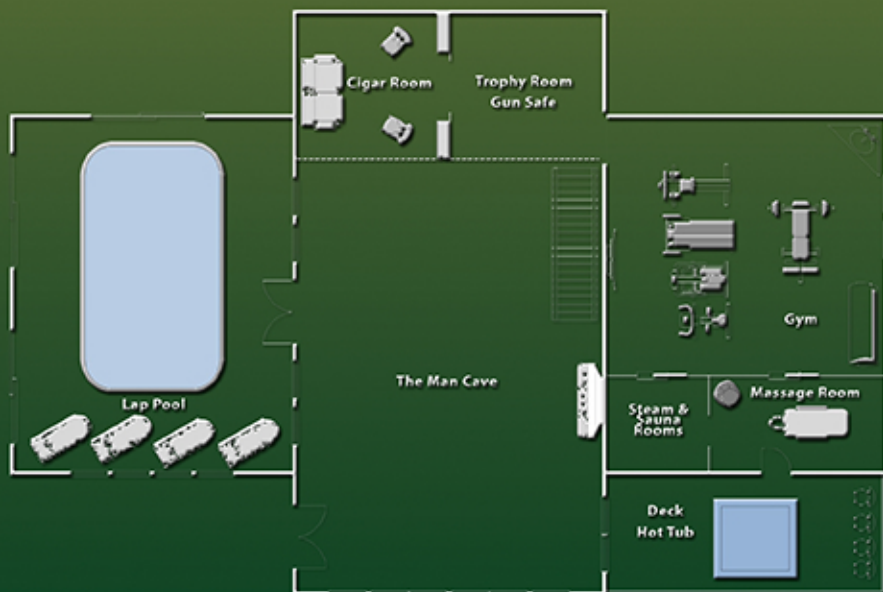

## Lower Level Floor Plan

1.800.661.LOGS



# The Elk Creek Lodge



7,158  
Square Feet





# The Elk Creek Lodge

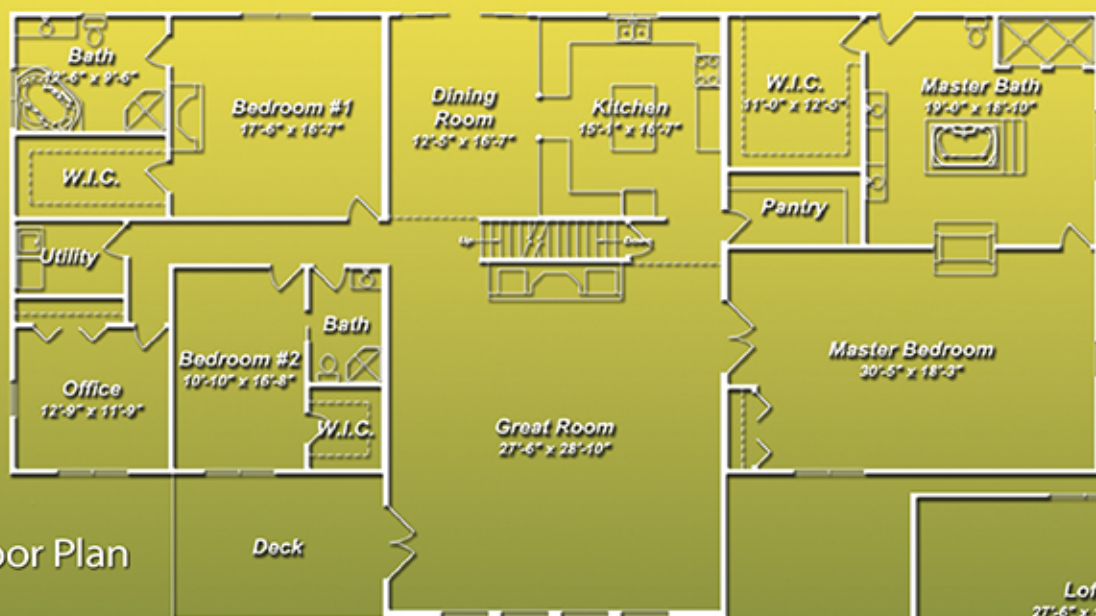

Second Floor Plan

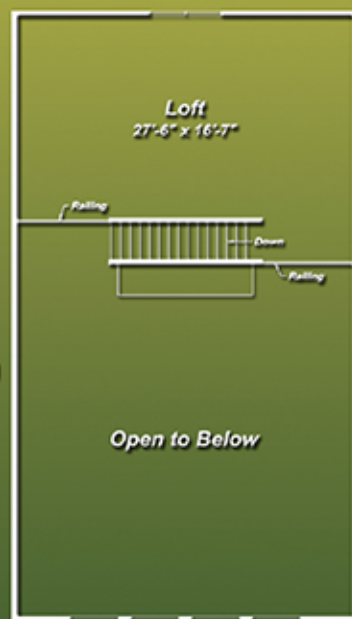

7,158  
Square Feet

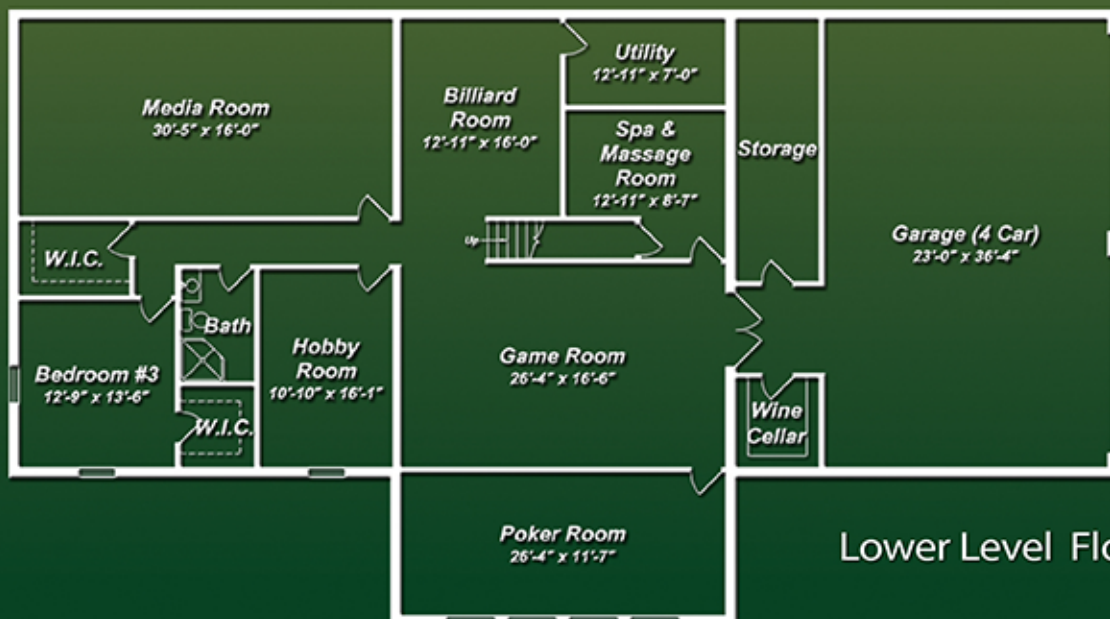





## Standard Log Home Package Materials List

### EXTERIOR WALL SYSTEM

6 X 6 "D" Log standard is all packages  
Northern White Cedar Logs (19 Courses)  
Matching Log Profile Siding for Dormers  
Matching Log Profile Siding for Gables  
Matching Log Profile Siding for Band Board  
Corner Post or Butt & Pass Corners standard  
Hardwood Dovetail Splines  
3/8" Hexlag Bolts  
Sikaflex Caulking  
Sure Seal Foam Gasket

### SECOND FLOOR SYSTEM

Exposed Heavy Beam Ceiling Joists  
(32" OC)  
Exposed Heavy Timber Carrier Beam  
(if span is under 14')  
Exposed Heavy Timber Posts  
(where required)  
2 x 6 NWC Tongue & Groove Decking  
Heavy Steel Joist Hangers (where required)

### PORCH ROOF SYSTEM

Exposed Heavy Timber Rafters  
Exposed Heavy Timber Posts ("RR" or Square)  
Exposed Heavy Timber Beams  
2 x 6 NWC Tongue & Groove Decking  
5/4 x 4 NWC Decking (Porch Floor)

### ROOF SYSTEM R 35+

Exposed Heavy Timber Rafters  
(32" OC)  
Exposed Heavy Timber Collar Ties  
(as required)  
Exposed Heavy Timber Posts ("RR" or Square)  
1 x 4 NWC Tongue & Groove Roof Decking  
1 x 4 NWC Tongue & Groove Decking  
(Soffit)  
Insulation Panels (7 1/2" Polystyrene  
Insulation with 7/16" OSB Laminate, 4' x 8')

### INTERIOR WALL SYSTEM

1 X 4 Tongue & Groove NWC  
(to cover all interior partition walls)  
1 x 4 Tongue & Groove NWC  
(to cover interior of Log Sided Gables)  
1 x 4 Tongue & Groove NWC  
(to cover interior of Log Sided Dormers)

### MISCELLANEOUS

Free Custom Design Service with CAD Blueprints  
Preliminary Laser Blueprints (PDF Format)  
Eight (8) Sets of Final Construction Prints  
Construction Manual  
Toll Free Number for Technical Assistance  
Freight FOB City of Origin  
10" x 1/4" Sip LD Fastener Screws  
(for insulation panels)



**Know the difference before you buy...**

## **NORTHERN WHITE CEDAR VS. PINE**

<b>Wood Specie</b>	<b>Northern White Cedar</b>	<b>Yellow &amp; White Pines</b>
<b>Characteristics</b>		
<b>Decay &amp; Rot Resistance</b>	<b>Yes</b>	<b>No</b>
<b>Low Moisture Content</b>	<b>Yes</b>	<b>No</b>
<b>Heartwood In Every Milled Log</b>	<b>Yes</b>	<b>No</b>
<b>Minimal Checking</b>	<b>Yes</b>	<b>No</b>
<b>High Natural Durability</b>	<b>Yes</b>	<b>No</b>
<b>Can Be Air-Dried</b>	<b>Yes</b>	<b>No</b>
<b>Checks Can Penetrate Heartwood</b>	<b>No</b>	<b>Yes</b>
<b>Left Untreated, Life Expectancy</b>	<b>50 + Yrs</b>	<b>3-7 Yrs</b>
<b>Moisture Content Per Cord</b>	<b>3500 lbs.</b>	<b>4700 lbs.</b>
<b>R-Value Per Inch</b>	<b>1.41</b>	<b>1.12</b>
<b>Thermal Mass Factor</b>	<b>3.78</b>	<b>2.76</b>

Upon reviewing this information, why would you build your dream home with any wood other than Northern White Cedar? This information is based on scientific research conducted by leading educational institutions and U.S. government agencies including the University of Maine, the United States Department of Agriculture, the Forest Products Laboratory, and the American Society of Heating, Refrigerating, and Air-conditioning Engineers.

Here's one simple question to ask yourself before you buy a Pine log home...Why would you build your dream home from a wood that you are not even allowed to use for an exterior deck unless it is chemically treated such as pressure-treated lumber? As stated in the International Residential Code, "Exterior decks must be constructed of either a naturally decay-resistance lumber (such as cedar cypress, or redwood) or a pressure-treated lumber (ACQ)..." We at Cedar Direct Log Homes are unsure why building codes will permit you to build an entire house from untreated white pine but they WILL NOT allow you to construct an exterior deck from the same wood unless chemically treated for decay and rot resistance. You be the judge.

### References

American Society of Heating, Refrigeration, and Air-conditioning Engineers. (2007). *ASHRAE Handbook*. Atlanta: ASHRAE.

Haataja, B. A., & Laks, P. E. (1995). Properties of Flakeboard Made From Northern White Cedar. *Forest Products Journal* , 45 (1), 68-70.

Hofmeyer, P. V., Kenefic, L. S., & Seymour, R. S. (2007). *Northern White Cedar*. Orono, ME: Cooperative Forestry Research Unit.

National Association of Home Builders. (2006). *International Residential Codes*. Washington D.C.: International Code Council.

USDA Forest Service. (1999). *WOOD HANDBOOK Wood as an Engineering Material*. Washington D.C.: Forest Products Laboratory.



## Begin the Adventure...

# Planning your log home

Designing and building a cedar log home is one of the exciting and rewarding experiences of your lifetime. Cedar log homes are equally suitable for a vacation home, a primary residence, a mountain home, a beach home, a retirement home, or even a starter home. This is also one of the most important financial investments that you will ever make. Whether you want to build a cozy week end retreat or a luxury estate, Cedar Direct International will be there to help you each step of the way. We can even help you design an addition for your existing log home. Each Cedar Direct log home is individually designed to fit your lifestyle, your taste, your family's individual needs, and most importantly your budget. We start with your list of "must haves", add in your design ideas, and mix well with your budgetary concerns to create your masterpiece.



In the design phase, you will work closely with our team to develop a design concept and establish a square footage size that fits your budget. We can design a log home according to your specifications or you can start with one of our existing plans and we can tweak it to fit your individual needs. Our plan book has been developed over many years and has a large variety of designs that are rustic, traditional, and contemporary. We also offer you complete design flexibility for your log home. We can help you create a home design that is totally and completely distinctive for you. Because nearly all of our log homes are either fully or partially custom designed, there is no additional cost for our custom design service.



After a design concept and budget are established, a free computerized log home package quote is done to give you the price of the complete log home package. At this point, Cedar Direct can assist you in a complete cost analysis and estimation regarding the total cost of your completed log home. Preliminary Blueprints are begun after you have signed the Custom Log Home Package Agreement with CDLH and have paid your initial deposit. Preliminary Blueprints are laser copies size 8.5" x 11" done in CAD. Once you have finalized your Preliminary Blueprints, we will begin the Final Construction CAD Blueprints. These are

usually 2' x 3' depending on the square footage of the home. These prints will show all the necessary information to construct your CDLH cedar log home. Eight sets of Final Construction CAD Blueprints are included with your custom log home package.

At Cedar Direct International, we will turn your dreams, ideas, and needs into reality by providing a cedar log home of enduring beauty with unsurpassed warmth, quality and luxury. Congratulations, you have taken the first important step in building your dream. Call us today to set up a private appointment to design your dream.



## The Adventure Continues...

# Designing your log home



At Cedar Direct, we build dreams and we believe your log home should reflect your dream, not a carbon copy of someone else's. That's why we offer state of the art computerized custom log home blueprinting and drafting for both the Preliminary and the Final Construction Blueprints free with the purchase of one of our complete log home packages. There is no additional charge for custom design!

After the initial design meeting to finalize decisions regarding your Preliminary Blueprints, you can expect to have your Preliminary Blueprints in 10 days to 2 weeks. For your convenience, these Preliminary Blueprints are presented to you in PDF format so that are easily emailed to you and to any contractors who are preparing material and labor quotes for your home. Only one set of Preliminary Blueprints are included with the purchase of your custom log home package. If you request an

additional set of Preliminary Blueprints, there will be an additional charge based on the complexity of the design and the square footage of the home. However, this will require an additional 2 weeks to draw. Once you have had a chance to fully review these plans and make any and all changes you want to make, you will need to sign off on these plans so that we can turn them into Final Construction Blueprints. Final window and door choices need to be also made prior to production of the Final Construction Blueprints. Preliminary Blueprints include the following pages:

1. First Floor Plan with dimensions and details
2. Second Floor Plan with dimensions and details
3. All four (4) elevations
4. Rough Opening Schedule for windows and doors showing the size of all windows and doors as drawn
5. Basement/Garage plan

Final Construction Blueprints are approximately 2' x 3' in size, but may vary due to the square footage of the house. Final Construction Blueprints contain the following pages:

1. Rough Opening Schedule for Windows and Doors
2. First Floor Plan
3. Second Floor Plan
4. Basement Plan
5. Front Elevation
6. Right Elevation
7. Left Elevation
8. Rear Elevation
9. Longitudinal Section
10. Foundation Plan
11. First Floor Joist Plan
12. Second Floor Joist Plan
13. Roof Rafter Plan
14. General Construction Details
15. Construction Details for Stairs and Decks

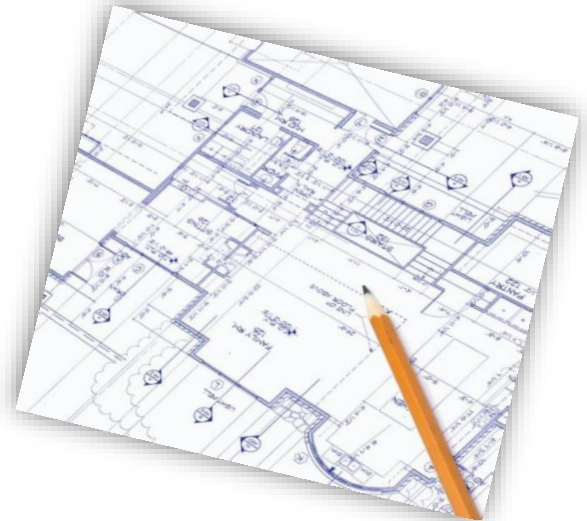

Changes requested to be made to the Final Construction Blueprints after submission and approval of the Preliminary Blueprints will be charged at an hourly rate with a 2 hour minimum. If your township/borough/county requires that the blueprints be sealed, Cedar Direct can provide this to you in the state of Pennsylvania for an additional charge. We will help you secure seals in other states or countries if required.

Bring us photos of the log homes you love or even a rough sketch of your plan and let us transform your ideas and dreams into a working set of blueprints. Envision your dream log home today!





# Cedar Direct Log Homes

10900 Perry Highway #202

Wexford, Pa 15090

888.503.LOGS (5647)